

# **EARTHWAY LF II COMMERCIAL BROADCAST SPREADER**

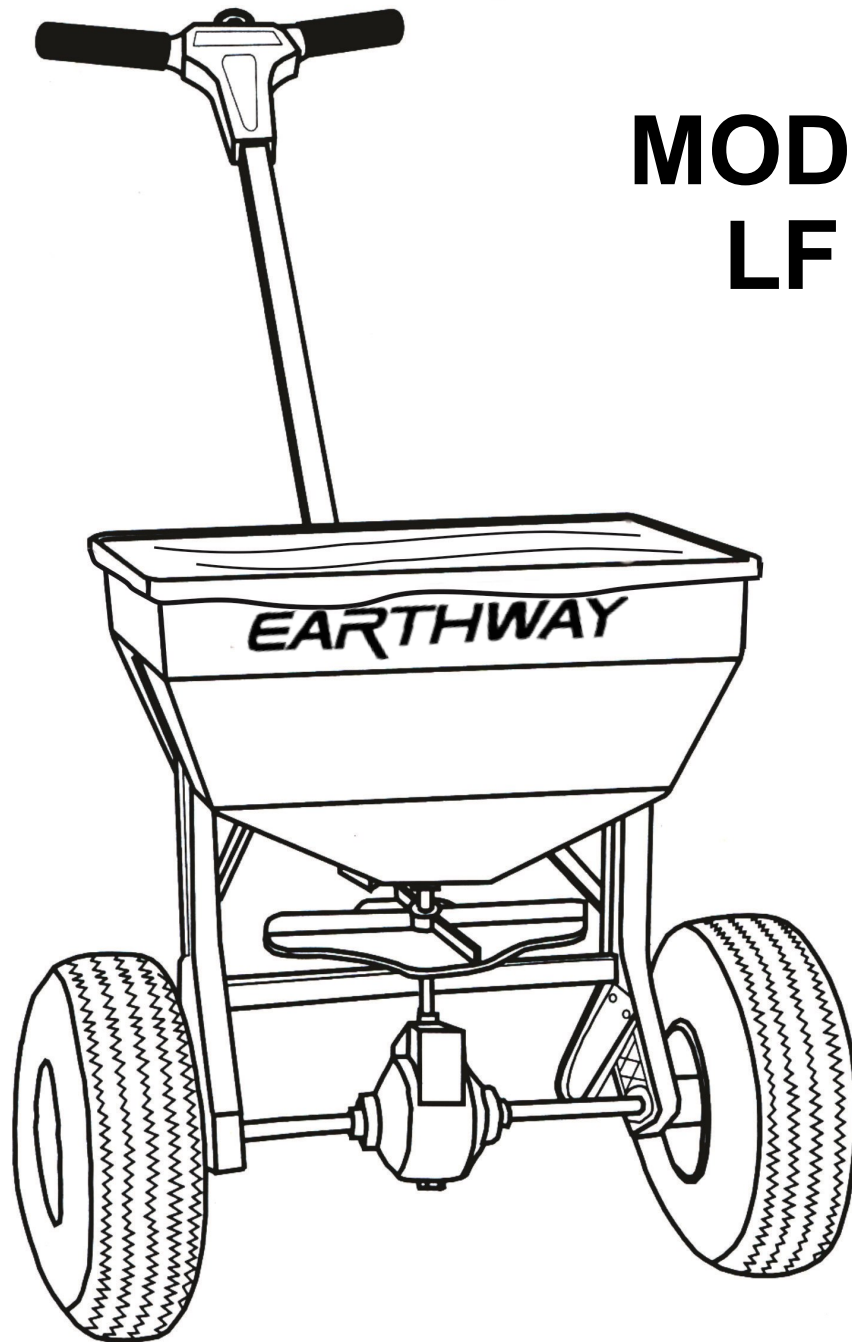

**MODEL  
LF II**

# **OWNER'S MANUAL**

# ASSEMBLY INSTRUCTIONS

**1.** Remove the spreader and components from the carton. Turn spreader upside down. Insert (2) 1/4-20 x 1 1/2" hex bolts through the flattened end of handle brace, frame and leg as shown. Install hex nuts but do not tighten. Repeat on opposite side.

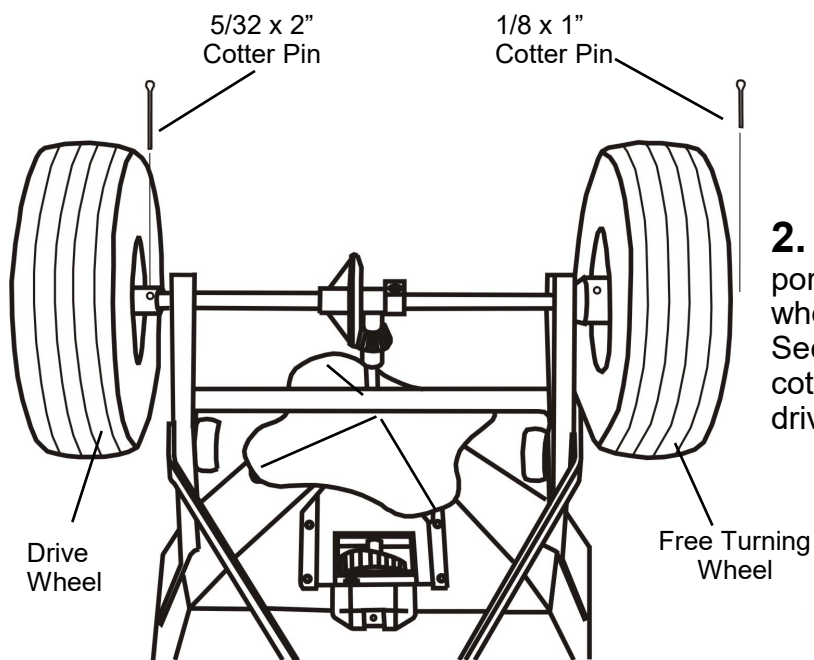
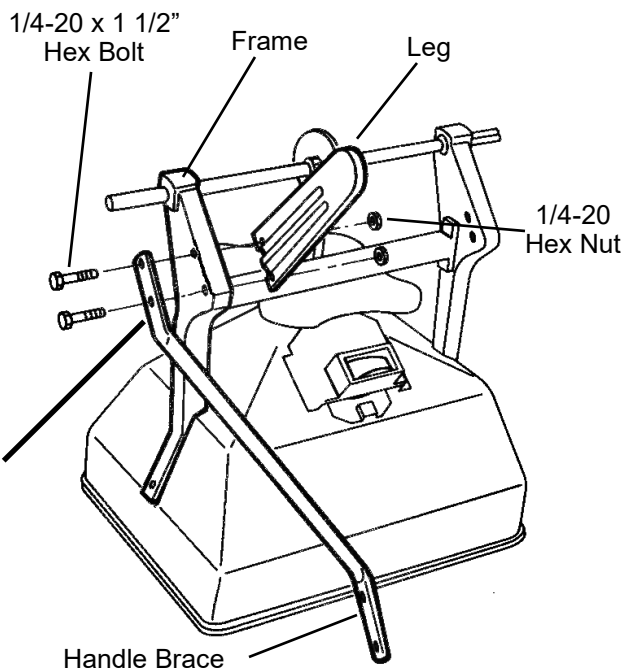

**VIEWED FROM REAR OF SPREADER**

**2.** Slide wheels onto axle with the longer portion of the wheel facing the frame. The wheels are identical to ease assembly. Secure free turning wheel with (1) 1/8 x 1" cotter pin and (1) 5/32 x 2" cotter pin on the drive wheel.

**3.** Turn spreader upright and install handle tube between braces. Secure with (2) 1/4-20 x 2" hex bolts and nuts. Tighten handle brace nuts installed in step 1.

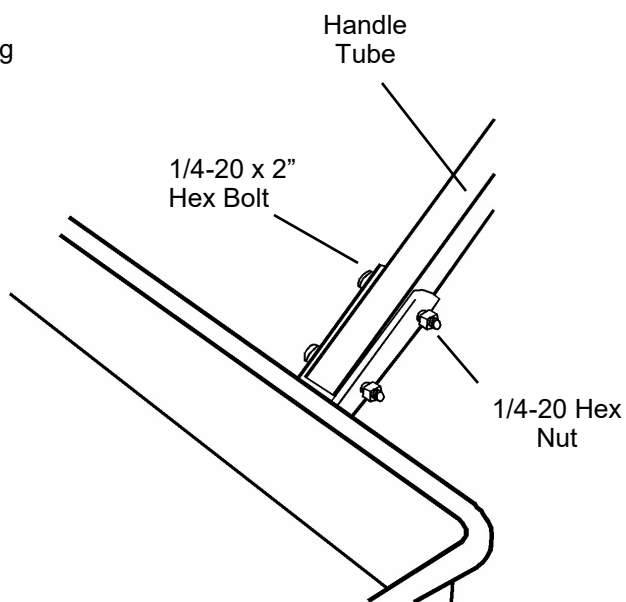

# ASSEMBLY, CONTINUED

**4.** Feed control knob/wire through the T-handle until spring touches the round hole. CAUTION: Do Not Compress Spring At This Time. Feed wire through the square handle tube. Be sure wire passes above the bolts in the handle brace. Secure T-handle to the tube with (1) 1/4-20 x 2" hex bolt, (2) washers, and (1) hex nut in the bottom hole, and (1) 1/4-20 x 2 1/4" hex bolt, (2) washers, and (1) hex nut in the top hole as shown. Remove caution label and push the thumb release toward the center and push down knob and shutoff spring until knob latches.

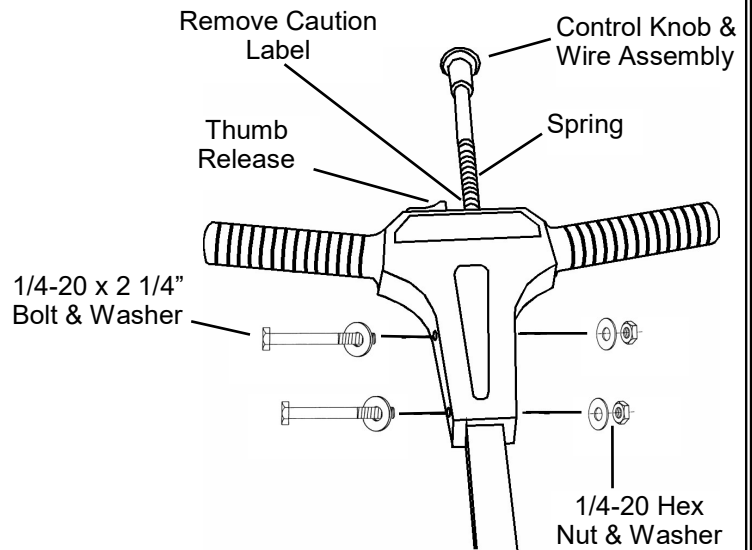

**CAUTION: ONCE KNOB IS LATCHED, DO NOT MOVE THUMB RELEASE UNTIL YOU HAVE COMPLETED STEP #5.**

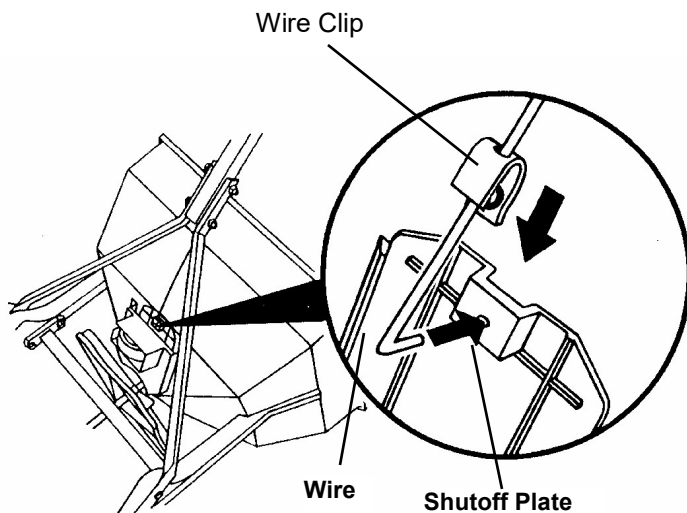

**5.** Slide wire retaining clip onto wire as shown. Insert wire through hole shutoff plate. Slide wire retaining clip over shutoff plate and wire until the clip locks into place.

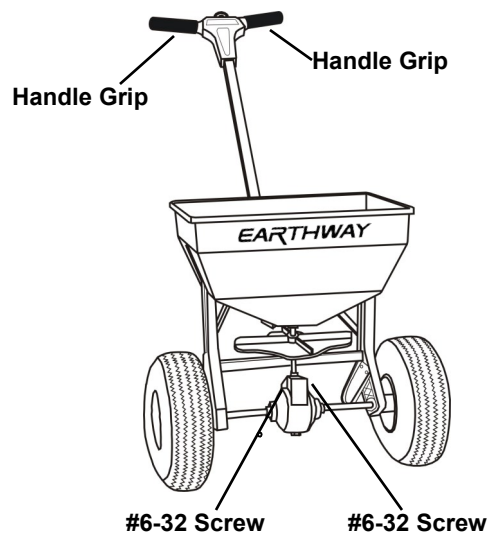

**6.** Install gear cover assembly over gears and secure with (2) #6-32 screws. Slide handle grips onto handle. Soapy water will ease installation. (Do not use petroleum based products.) The LFII spreader should now be completely assembled and ready for use.

# SPREADER OPERATION

**1.** Check the product package for the rate setting, and recommended swath width. Turn the spreader off by pushing the control knob in. Rotate the rate cam to the proper setting.

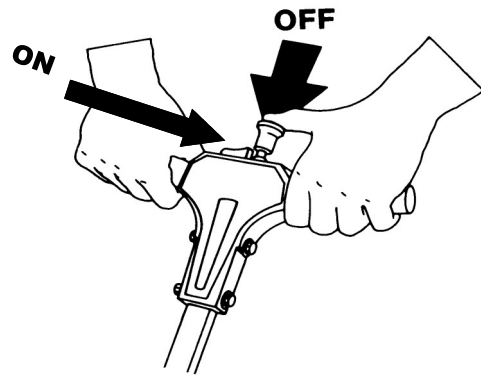

**2.** Always fill the spreader on the driveway or sidewalk-not on the lawn. Make sure spreader is in the "OFF" position. Empty after each use.

**3.** Start spreader moving, then open spreader by pushing the thumb release to the "ON" position. Always push spreader, never pull. Push knob down to close spreader.

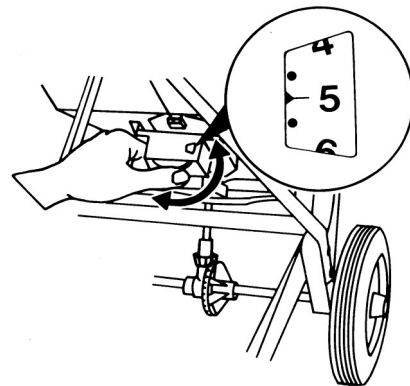

**4.** Hold handle so top of spreader is level. Tipping the spreader too far can cause uneven spreading.

**5.** The settings and swath widths on the product label are recommended starting points. Always check the delivery rate and pattern on a small area before treating a large area. Actual delivery rate can vary due to weather conditions, operating variables, and condition of the product being applied. See "HOW TO DETERMINE SPREADER SETTING AND SWATH WIDTH" for details.

**6.** Push spreader 3 1/2 m.p.h. (26 feet in 5 seconds) for full 8' to 10' spread pattern when applying fertilizer products. Apply header strips at each end of area to be treated then space trips across the area as shown.

**7.** Push spreader at 2 1/2 mph (18 feet in 5 seconds) to reduce width of spread when applying ice melt products to sidewalks.

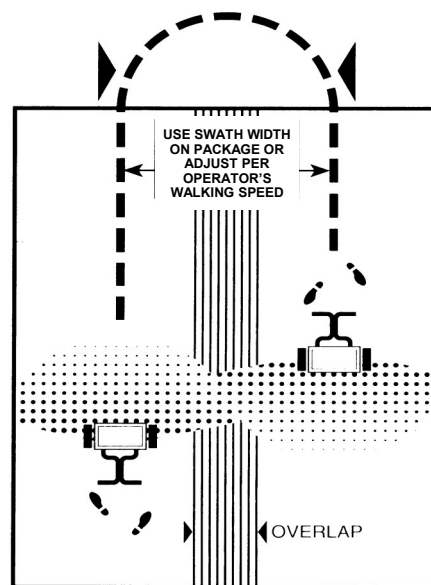

**8.** Empty spreader after each use. Return leftover material to its original container.

# HOW TO DETERMINE SPREADER SETTINGS AND SPREAD WIDTH

Two major factors should be considered when determining correct spreader settings of any product:

1. The product application rate, or the amount of material applied per 1,000 square feet.
2. The effective pattern width, or the actual width in which material is applied. Label settings are a guide and can be affected by numerous factors.

## EFFECTIVE PATTERN WIDTH

A simple visual pattern test can be made by operating the spreader over a non-turf area and evaluating the pattern. A more accurate method is to place a row of common, disposable, aluminum cake pans approximately 1 foot on centers. Set the rate cam at a middle setting and make 3 or 4 passes in the same direction as shown. Pour the material collected from each pan into individual bottles of the same size. Set them side by side in order, and visually inspect their volume. The effective pattern width is the distance out from the spreader to a point where the amount of material is 1/2 the average amount in the center pans. This distance is multiplied by 2 to achieve the total effective pattern width.

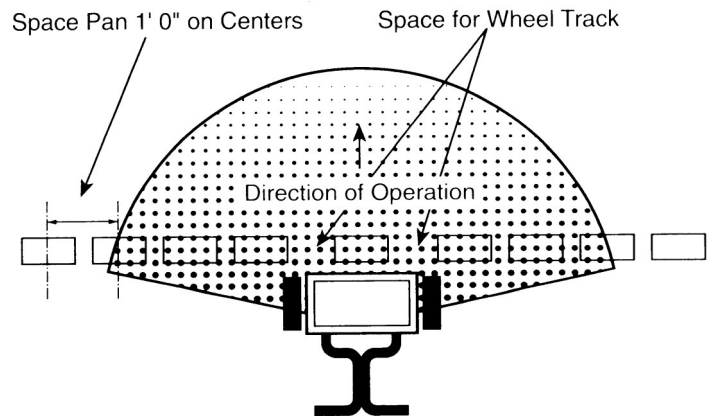

## APPLICATION RATE

Knowing the effective pattern width (for example, 10 feet), measure a distance equal to 100 square feet (10' x 10' swath width). Determine the product coverage is pounds/ 100 sq. ft. by the recommended square foot coverage (add two zeroes to the weight of the bag).

EXAMPLE: Product weight: 25 lbs.  
sq. ft. coverage: 5,000 sq. ft.  
2500 lbs. - 5,000 sq. ft.  
= .5 lbs. / 100 sq. ft.





Weigh out between 15 to 20 lbs. of material and spread over the 100 sq. ft. area. Weigh remaining material left in hopper and adjust rate setting as required. Repeat test until application rate is correct.

# RATE SETTING CONVERSION

The following provides approximate EARTHWAY LF<sub>II</sub> settings for those units listed.

<b>EARTHWAY LF<sub>II</sub> Setting</b>	2	2 1/2	3	3 1/2	4	4 1/2	5	5 1/2	6	6 1/2	7	7 1/2	8	8 1/2	9
<b>EARTHWAY CBRIV/ CBRIVSS</b>	E	G	I	J	K	L	M	N	O	P 1/2	R	T	W	Y	Z
<b>EARTHWAY ROTARY (2150/2600A- Plus/2050P ect.)</b>	9	11	13	14	15	16	17	18	19	21	23	24	26	28	30
<b>ANDERSONS SR2000/AP2000</b>	G	I	K	L	M	N	O	P	Q	R 1/2	T	U 1/2	W 1/2	Y	Z

The following provides approximate EARTHWAY LF<sub>II</sub> settings when only the product weight, square foot coverage, and visual inspection of the material is available.

<b>FERTILIZER PARTICLE SIZE</b>	<b>BAG RATE</b> Pounds of fertilizer used per 1,000 sq. ft. of coverage	<b>APPROX. SETTING</b>	<b>SPREAD WIDTH (IN FEET)</b>
<b>Large, heavy particles</b> 	5	3 1/2	8
	10	4	8
	15	4 1/2	8
<b>Medium- mixed particles</b> 	5	2 1/2	8
	10	3 1/2	8
	15	4	8
<b>Small particles (nitrogen)</b> 	1	2	8
	2	2 1/2	8
	3	3	8
<b>Mixed size particles -some fines</b> 	5	3	6
	10	3 1/2	6
	15	4	6
<b>Light weight particles</b> 	5	2	4
	10	2 1/2	To
	15	3	6

Conversions should be used as guidelines for establishing proper rate settings. To obtain the most accurate application rate, follow the procedures described in the Effective Pattern Width and Application Rate sections. The settings shown here are only approximations and will vary due to physical characteristics of the product, walking speed, turf condition, humidity, etc. Warranty and guarantees of actual coverage or uniformity are neither expressed nor implied.

# MAINTENANCE

1. Never store unused material in spreader. Return unused product to its original container.
2. Wash spreader thoroughly after each use and dry completely in sun or heated area.
3. Oil the axle bearings, impeller shaft bearing in hopper, control knob in the T-handle.
4. Remove gear cover and wash gears thoroughly. Oil all bearing areas and face of gear teeth. Re-install gear cover.
5. Gear mesh should be checked on a regular basis during high use periods. Clearance between the axle gear and pinion gear should be minimal but not tight. If adjustment is necessary, loosen axle collar set screw and hold gears together. Slide axle collar against the gear support and tighten axle collar set screw. Spin drive wheel. Gears should run freely and smoothly.
6. Impeller surface should be cleaned periodically to remove build-up of product. Build-up can cause the spread pattern to change.
7. Tire pressure should be 20-25 PSI.

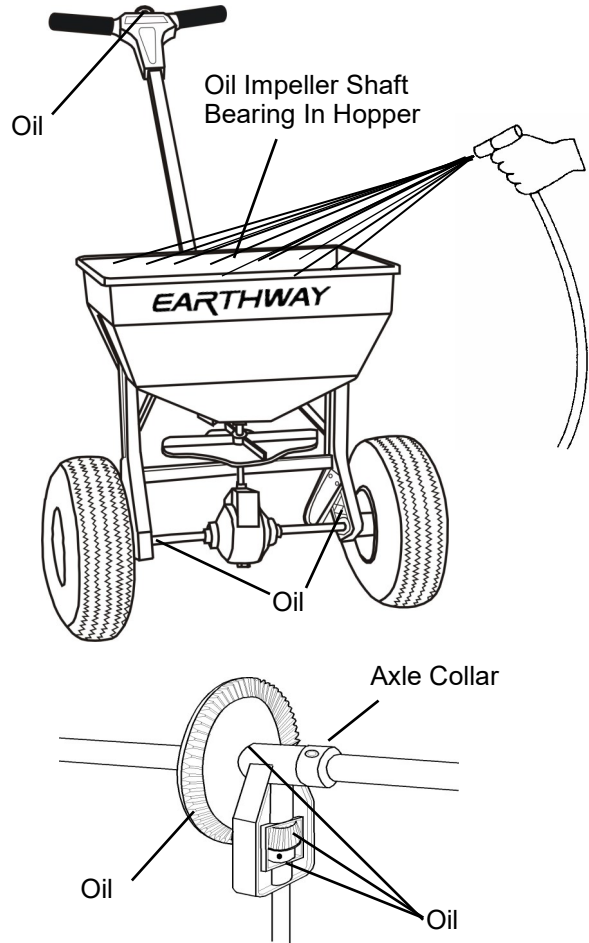

# WARRANTY

## One Year Limited Warranty

EarthWay Products, Inc. provides this limited warranty that this product is free of defects in original workmanship and materials for a period of one year to the end user with the original purchase receipt. If a manufacturing non-conformance is found, EarthWay Products, Inc. at its discretion will repair or replace the part(s)/product at no charge provided the failure is not the result of incorrect installation, mishandling, misuse, tampering, improper storage, or normal wear and tear as determined by EarthWay. Due to the corrosive nature of most fertilizers and ice melt products, EarthWay Products, Inc. makes no warranty against and specifically excludes part(s) or product degradation or failure due to corrosion or its effects.

EarthWay at its discretion may require that the part(s) or product be returned along with the original purchase receipt for examination and compliance with the terms of this limited warranty. Do not return any product without first receiving authorization from EarthWay Products, Inc. IN NO EVENT SHALL EITHER PARTY BE LIABLE TO THE OTHER FOR SPECIAL, INDIRECT, INCIDENTAL, OR CONSEQUENTIAL DAMAGES, EVEN IF SUCH PARTY SHALL HAVE BEEN ADVISED OF THE POSSIBILITY OF THE SAME.

To seek remedy under this limited warranty, contact EarthWay Products, Inc. at [support@earthway.com](mailto:support@earthway.com) or write to EarthWay Products, Inc. 1009 Maple Street, Bristol, IN 46507, and describe the nature of the manufacturing defect. SPECIFIC LIMITATIONS: This limited warranty covers only the part(s) or product; any labor charges associated with the repair or replacement of non-conformances are specifically excluded.

The above-listed warranty procedure is a condition precedent to bringing any legal action to enforce this limited warranty. Any action to enforce any portion of this limited warranty must be commenced within ninety days after the expiration of the limited warranty coverage period. Any performance of repairs will not suspend this limitation period from expiring unless state law provides otherwise. Any performance of repairs after the limited warranty coverage period has expired, or performance of repairs regarding anything excluded from coverage under this limited warranty shall be considered "goodwill" repairs, and they will not change the express terms of this limited warranty or extend the limited warranty coverage period.

Exclusive jurisdiction for deciding legal disputes relating to alleged breach of warranty or representations of any nature relating to this limited warranty must be filed in the courts of Elkhart County within the State of Indiana. Any and all claims, controversies, and causes of action arising out of or relating to this limited warranty, whether sounding in contract, tort, or statute, will be governed by the laws of the State of Indiana, without giving effect to any choice or conflict of law provision or rule. NO OTHER WARRANTY, EXPRESS, IMPLIED, OR STATUTORY, SHALL APPLY, INCLUDING, BUT NOT LIMITED TO, ANY IMPLIED WARRANTY OF MERCHANTABILITY, APPLICATION, OR FITNESS FOR A PARTICULAR PURPOSE, OR ANY OTHER WARRANTY OBLIGATION ON THE PART EARTHWAY, AND ALL SUCH WARRANTIES ARE EXPRESSLY DISCLAIMED. In the event that applicable law prevents the disclaimer of any implied warranties, then such implied warranty shall be limited to the fullest extent permitted by law. Without limiting the foregoing, if applicable prevents the disclaimer of any such implied warranties, this limited warranty limits the period of time in which a claim for breach of implied warranties, including but not limited to the implied warranty of merchantability or fitness for a particular purpose, may be filed. In such event, any claim for breach of implied warranty must be brought before the expiration of this express limited warranty's one-year term.

# PARTS LIST FOR EARTHWAY LF II

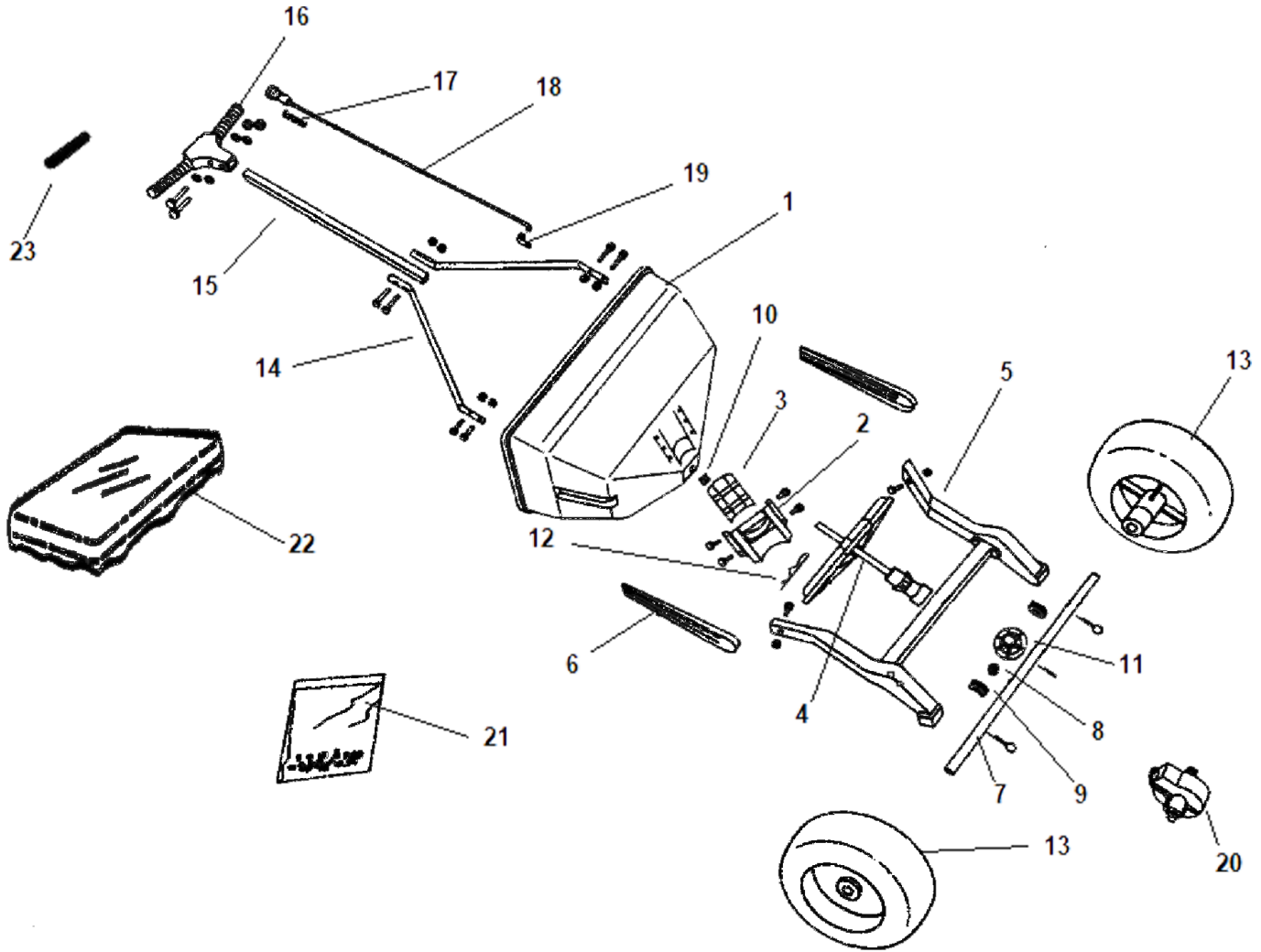

Key No.	Description	Part No.	Key No.	Description	Part No.
1	Hopper Ass'y-includes	60455	12	Agitator	33117
2	Rate Cam & Chute	P15450	13	Drive & Free Turning	70106
3	Shutoff Plate	P15454	14	Handle Braces (2)	P136131-
4	Impeller Assembly	15849	15	Handle Tube	P145132-
5	Frame Assembly	P16421	16	T-Handle Assembly	13634-2
6	Legs (2)	P136191-04	17 & 18	Control Knob & Wire	P146151
7	Axle	15842	19	Wire Retaining Clip	13643-1
8	Axle Collar	14634	20	Gear Cover Assembly	13623-1
9	Axle Bushings (2)	14951	21	Fastener Package	15880
10	Impeller Shaft Bearing	15833	22	Hopper Cover	15209
11	Axle Gear	13625-1	23	Handle Grip (2)	15264